

PROJECT REFERENCE NO.	SHEET NO.
17BP.2.R.68	4
RW SHEET NO.	
ROADWAY DESIGN ENGINEER	HYDRAULICS ENGINEER
INCOMPLETE PLANS DO NOT USE FOR R/W ACQUISITION	
DOCUMENT NOT CONSIDERED FINAL UNLESS ALL SIGNATURES COMPLETED	

W2
 PERMANENT WETLAND IMPACTS = 0.0 Ac / 0 SF
 MECHANIZED CLEARING IN WETLANDS = 0.0 Ac / 0 SF
 PERMANENT STREAM IMPACTS = 0 LF
 TEMPORARY STREAM IMPACTS = 0 LF

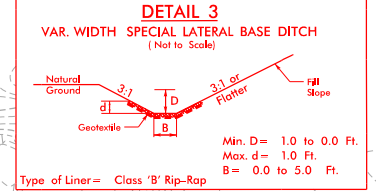

W1
 PERMANENT WETLAND IMPACTS = 0.0 Ac / 0 SF
 MECHANIZED CLEARING IN WETLANDS = 0.0 Ac / 0 SF
 PERMANENT STREAM IMPACTS = 0 LF
 TEMPORARY STREAM IMPACTS = 0 LF

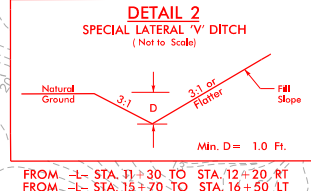
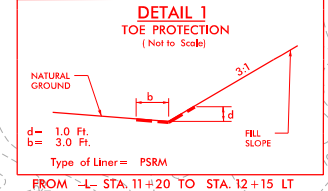
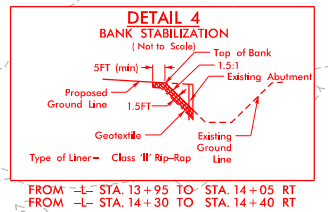

W3
 PERMANENT WETLAND IMPACTS = 0.0 Ac / 0 SF
 MECHANIZED CLEARING IN WETLANDS = 0.0 Ac / 0 SF
 PERMANENT STREAM IMPACTS = 0 LF
 TEMPORARY STREAM IMPACTS = 0 LF

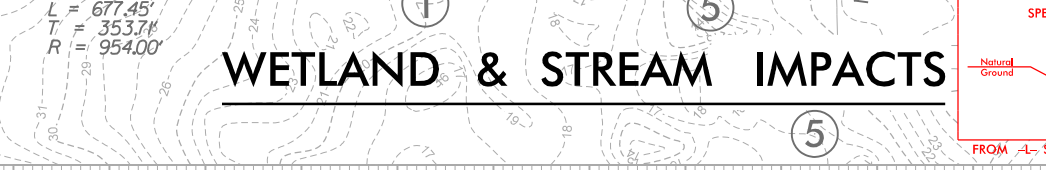

W4
 PERMANENT WETLAND IMPACTS = 0.0 Ac / 0 SF
 MECHANIZED CLEARING IN WETLANDS = 0.0 Ac / 0 SF
 PERMANENT STREAM IMPACTS = 0 LF
 TEMPORARY STREAM IMPACTS = 0 LF

WETLAND & STREAM IMPACTS

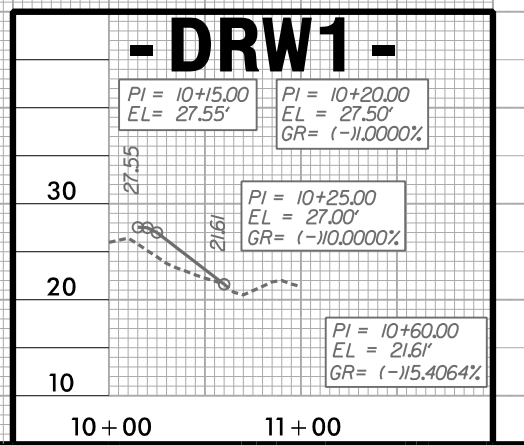
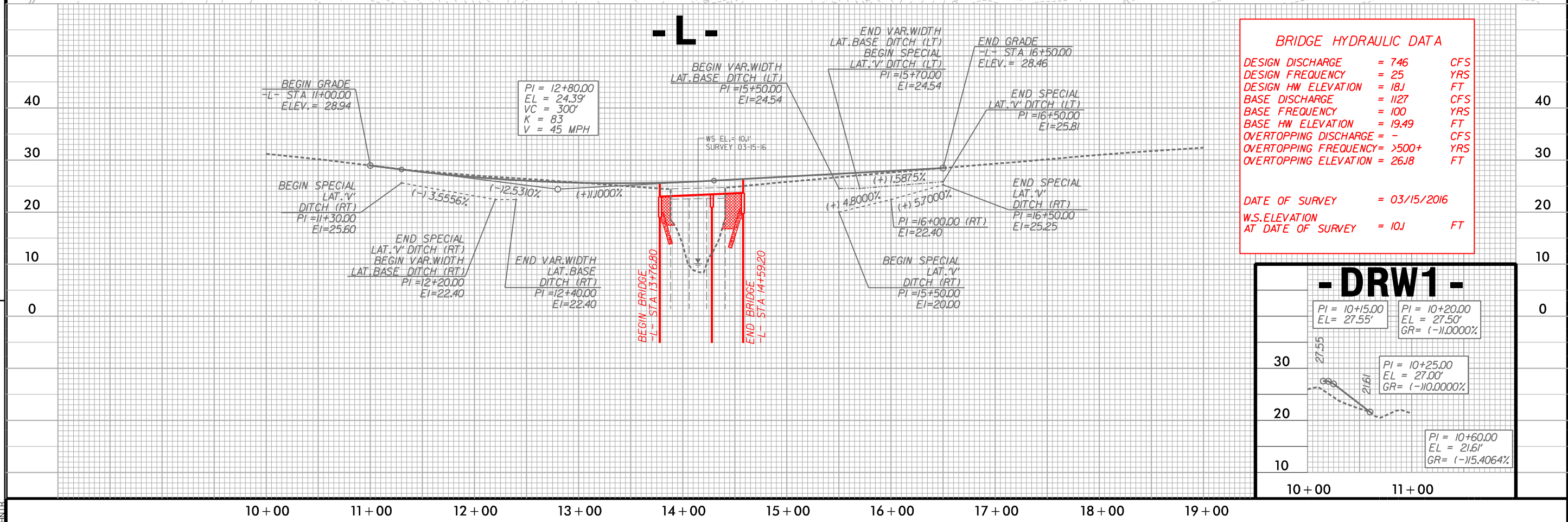

REVISIONS

3:34:03 PM h:\hyd_p\rm_01.dgn

B2
 ZONE 1 BUFFER IMPACTS = 160 SF
 ZONE 2 BUFFER IMPACTS = 75 SF

B1
 ZONE 1 BUFFER IMPACTS = 265 SF
 ZONE 2 BUFFER IMPACTS = 175 SF

B3
 ZONE 1 BUFFER IMPACTS = 0 SF
 ZONE 2 BUFFER IMPACTS = 0 SF

B4
 ZONE 1 BUFFER IMPACTS = 150 SF
 ZONE 2 BUFFER IMPACTS = 80 SF

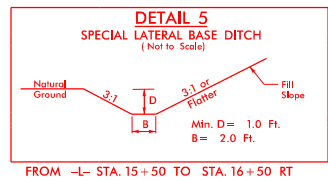
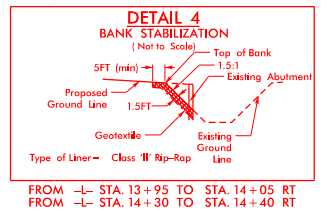
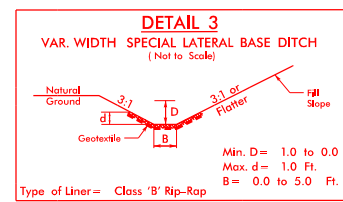
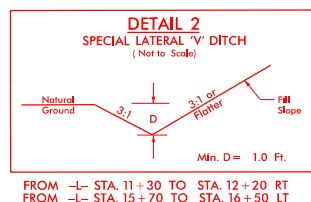
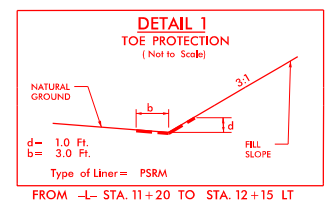

5 BUFFER IMPACTS

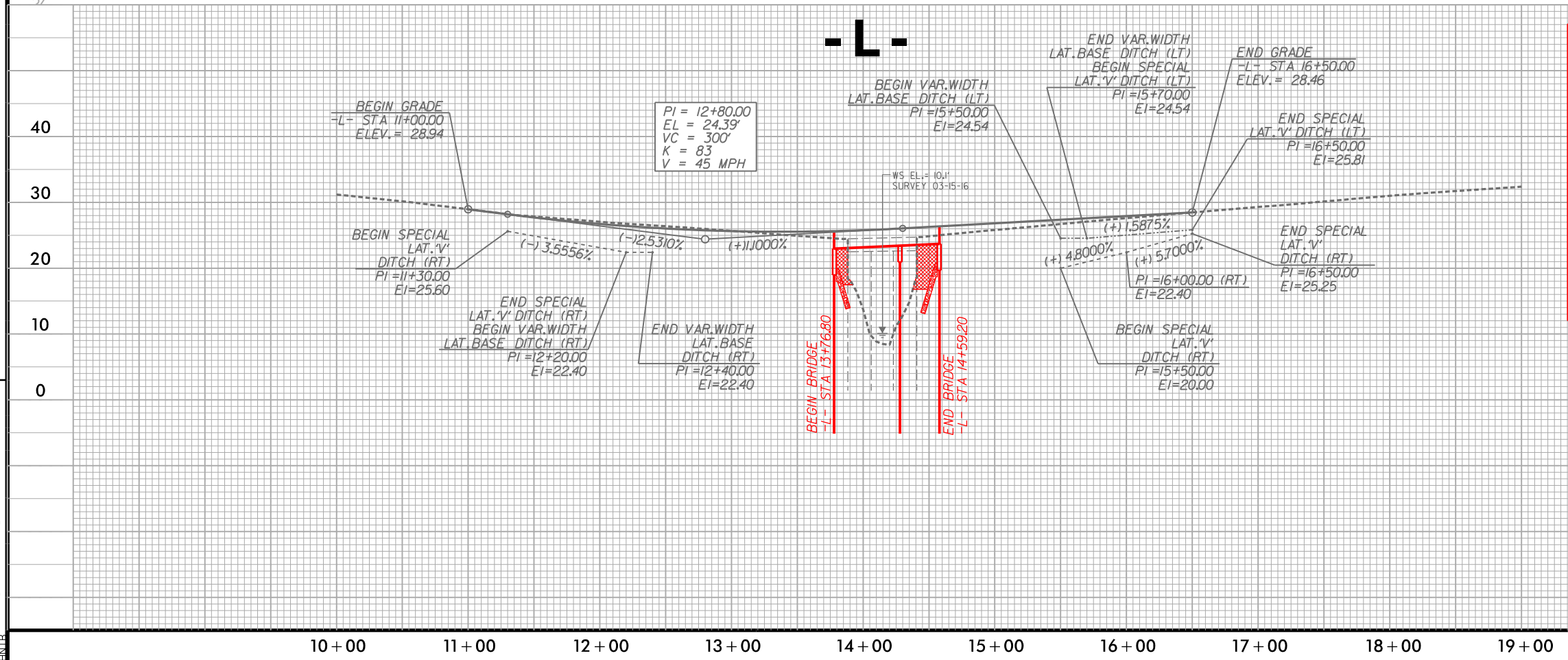

BRIDGE HYDRAULIC DATA

DESIGN DISCHARGE	= 746	CFS
DESIGN FREQUENCY	= 25	YRS
DESIGN HW ELEVATION	= 18J	FT
BASE DISCHARGE	= 1127	CFS
BASE FREQUENCY	= 100	YRS
BASE HW ELEVATION	= 19.49	FT
OVERTOPPING DISCHARGE	= -	CFS
OVERTOPPING FREQUENCY	= >500+	YRS
OVERTOPPING ELEVATION	= 26J8	FT

DATE OF SURVEY = 03/15/2016
 W.S. ELEVATION AT DATE OF SURVEY = 10J FT

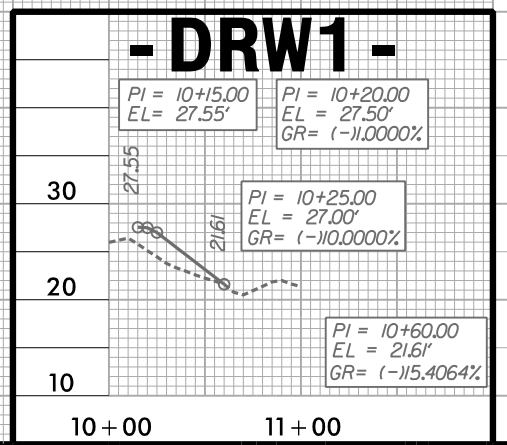

REVISIONS

8/17/99

4:07:54 PM hntb_hyd_buff_01.dgn

PROJECT REFERENCE NO.	SHEET NO.
17BP.2.R.68	4
RW SHEET NO.	
ROADWAY DESIGN ENGINEER	HYDRAULICS ENGINEER
INCOMPLETE PLANS DO NOT USE FOR R/W ACQUISITION	
DOCUMENT NOT CONSIDERED FINAL UNLESS ALL SIGNATURES COMPLETED	

B2
 ZONE 1 BUFFER IMPACTS = 160 SF
 ZONE 2 BUFFER IMPACTS = 75 SF

B1
 ZONE 1 BUFFER IMPACTS = 265 SF
 ZONE 2 BUFFER IMPACTS = 175 SF

B3
 ZONE 1 BUFFER IMPACTS = 0 SF
 ZONE 2 BUFFER IMPACTS = 0 SF

B4
 ZONE 1 BUFFER IMPACTS = 150 SF
 ZONE 2 BUFFER IMPACTS = 80 SF

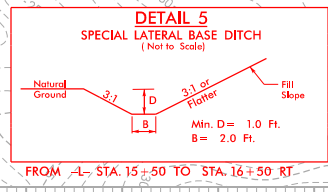
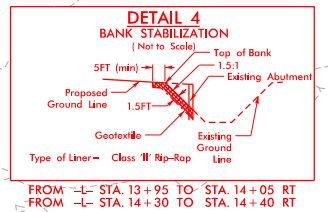
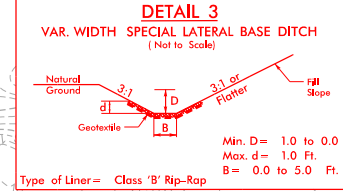
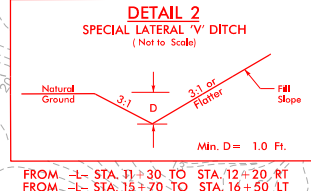
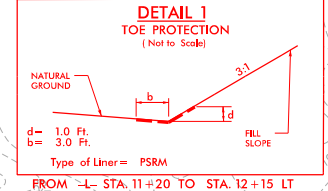

BUFFER IMPACTS

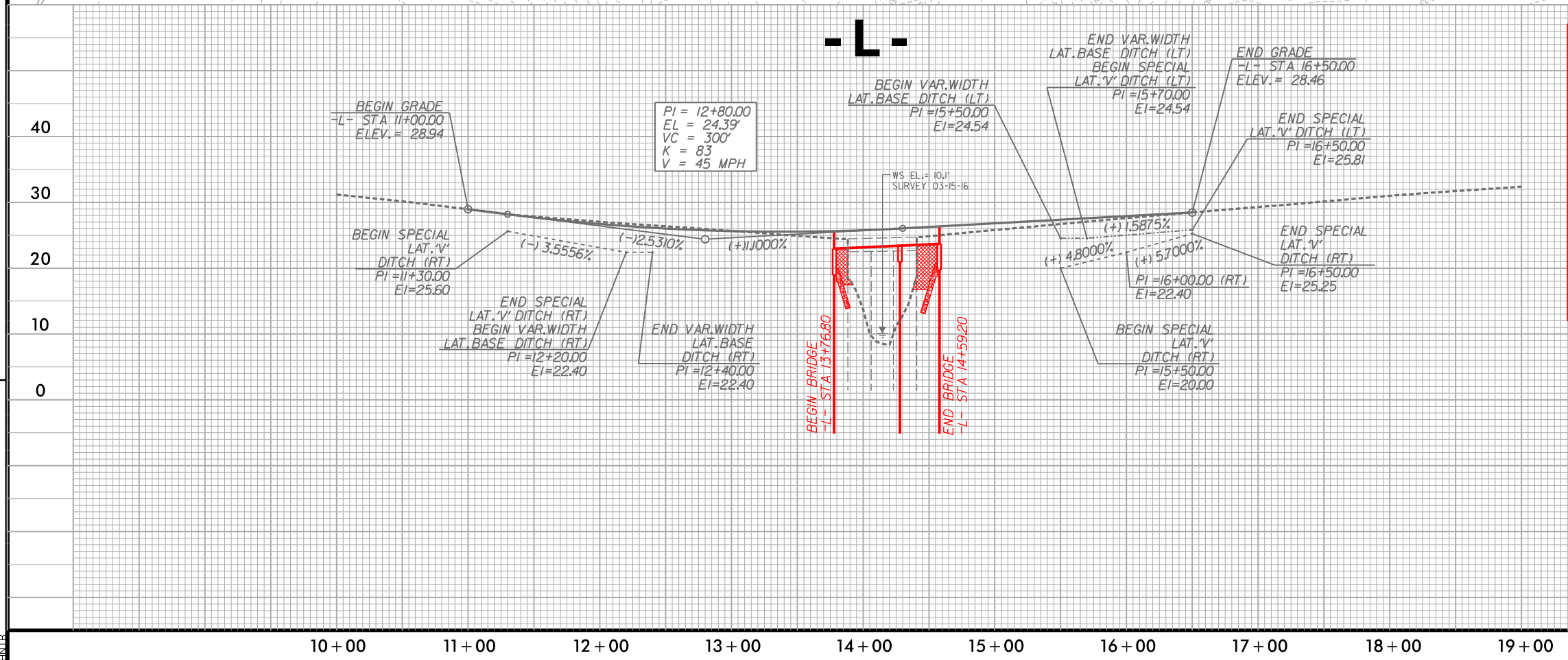

BRIDGE HYDRAULIC DATA

DESIGN DISCHARGE	= 746	CFS
DESIGN FREQUENCY	= 25	YRS
DESIGN HW ELEVATION	= 18J	FT
BASE DISCHARGE	= 1127	CFS
BASE FREQUENCY	= 100	YRS
BASE HW ELEVATION	= 19.49	FT
OVERTOPPING DISCHARGE	= -	CFS
OVERTOPPING FREQUENCY	= >500+	YRS
OVERTOPPING ELEVATION	= 26J8	FT

DATE OF SURVEY = 03/15/2016
 W.S.ELEVATION AT DATE OF SURVEY = 10J FT

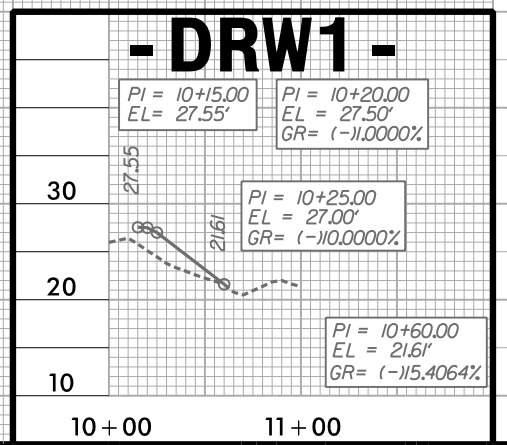

REVISIONS